

Permaban Beta / Eclipse Expansion Installation Guide

Using AlphaFix Method

Installation Guide Issue V1.0

14/07/22

01 Placing the Eclipse Joint

Place Joints on the floor with Sleeves pointing up.

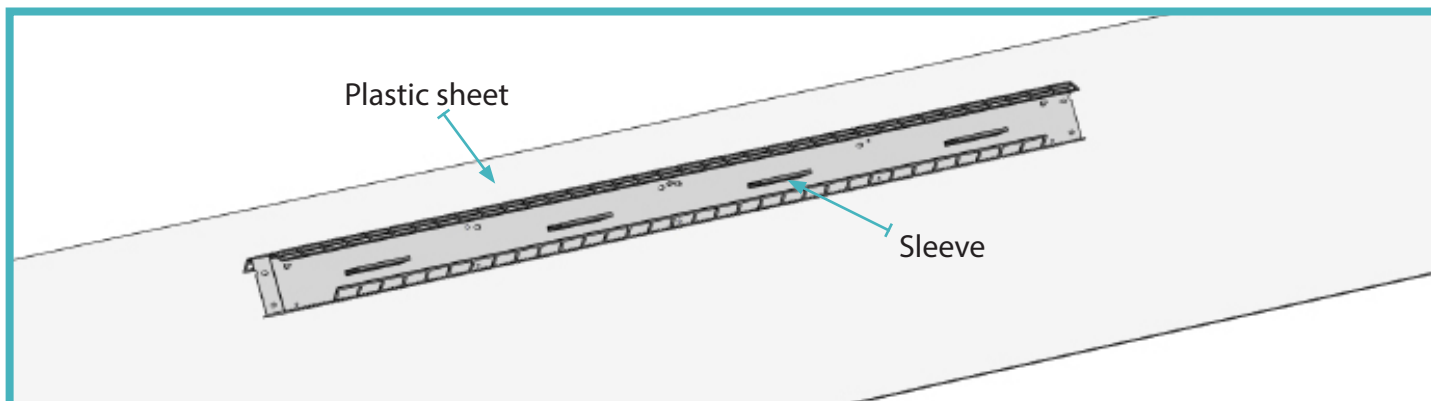

02 Put Joints together

Fix two AlphaFix to the Joint, then stand the Joints end to end. Then fix together using the install Kit provided through the Joints fixture assembly holes.

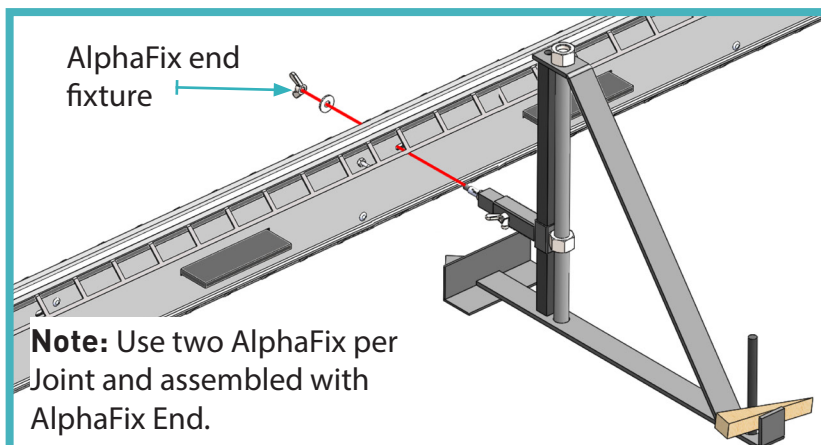
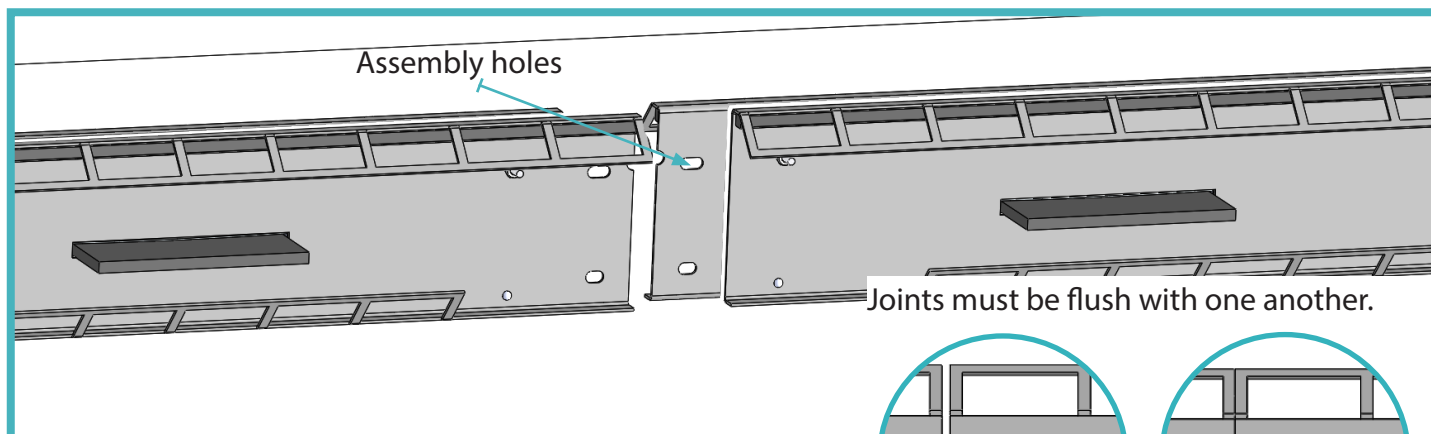

Note: Use two AlphaFix per Joint and assembled with AlphaFix End.

Permaban Beta / Eclipse Expansion Installation Guide

Using AlphaFix Method

Installation Guide Issue V1.0
14/07/22

03 Adjust to Height / Level Joints

Use the connected AlphaFix to adjust the height of the Joint. A wedge can then be used in between the Joint and AlphaFix kick stand to prevent kicking of the Joint.

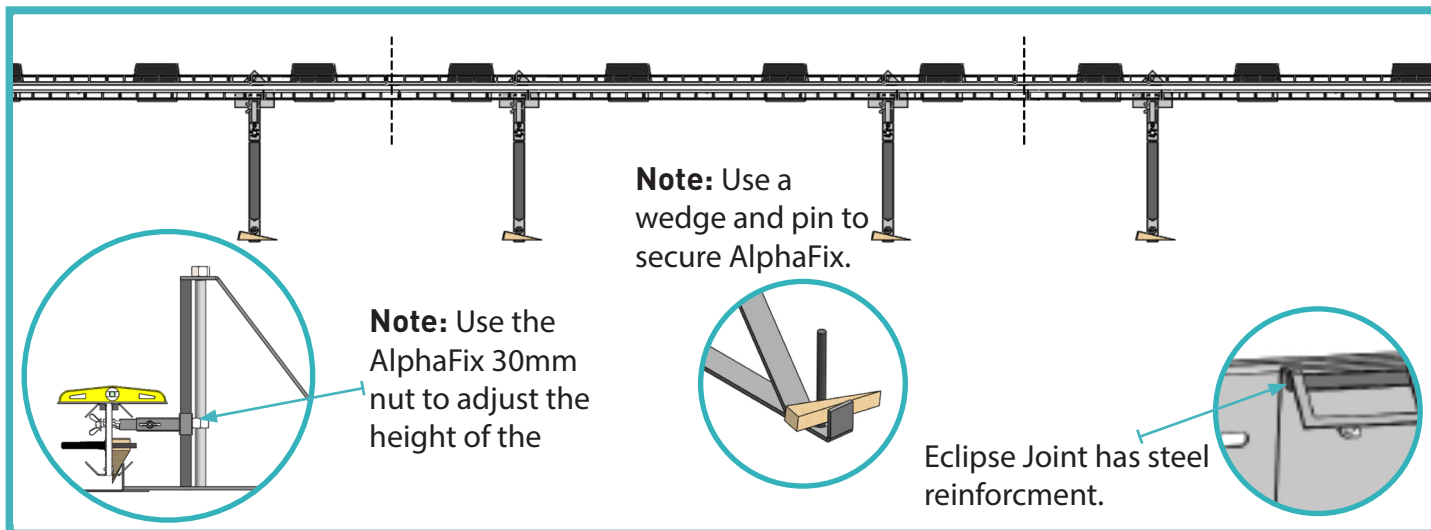

Note; Check the Joint is level in the 3 positions.

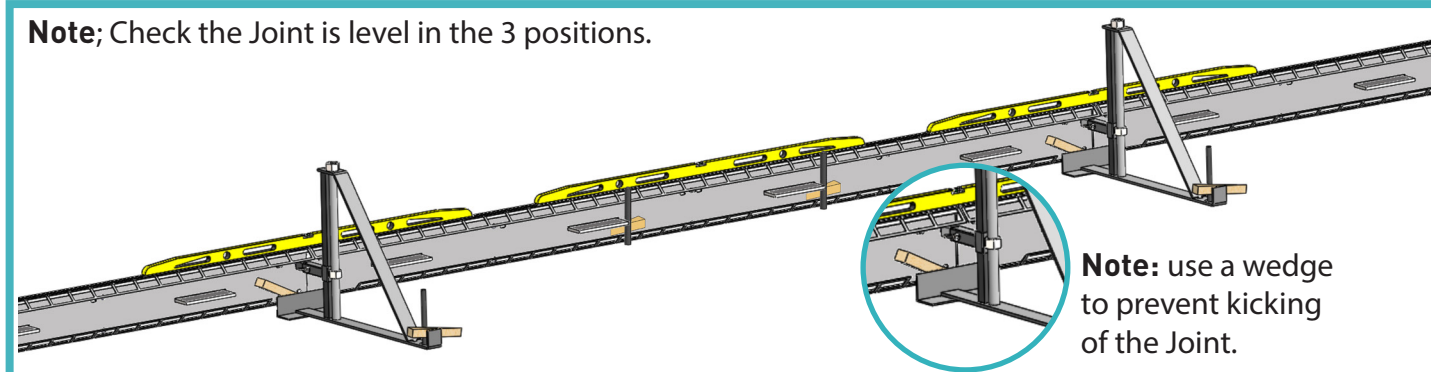

Measure the horizontal level using the top strip.

Note; Joints must be fixed at 90°.

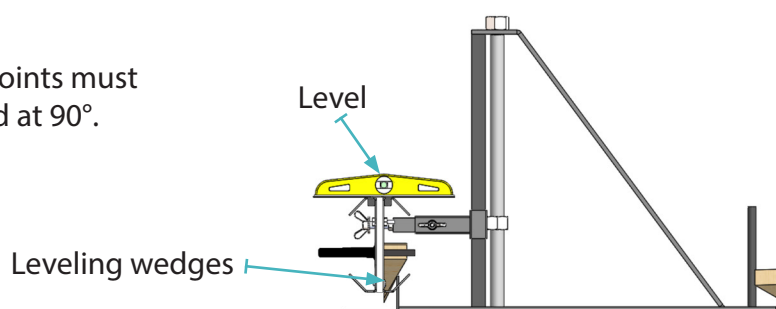

Permaban Beta / Eclipse Expansion Installation Guide

Using AlphaFix Method

Installation Guide Issue V1.0
14/07/22

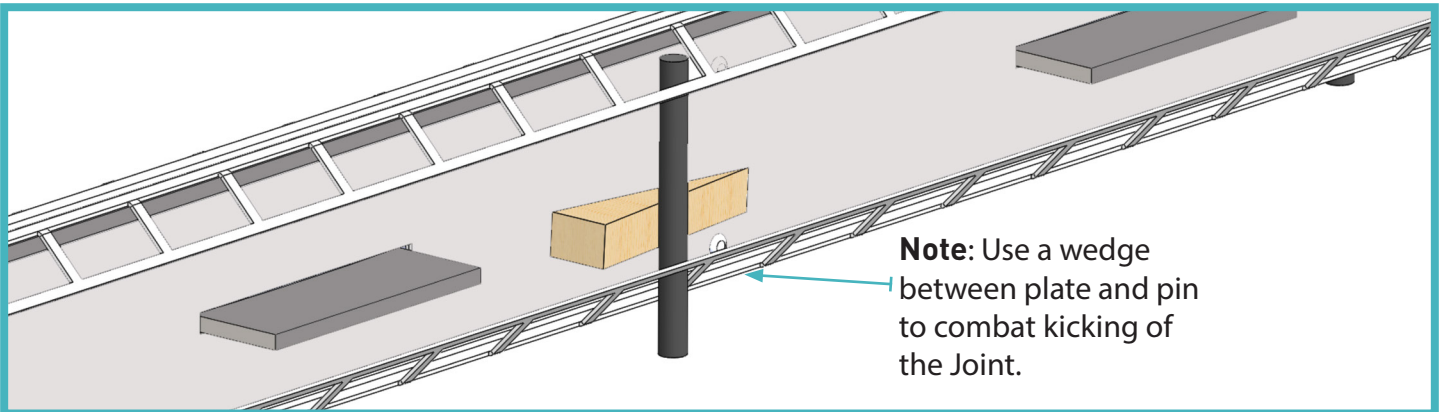

04 Vibrate Concrete

After the concrete is set, remove the AlphaFix and the AlphaFix end. Poker vibrate along length of the Joint to compacted concrete.

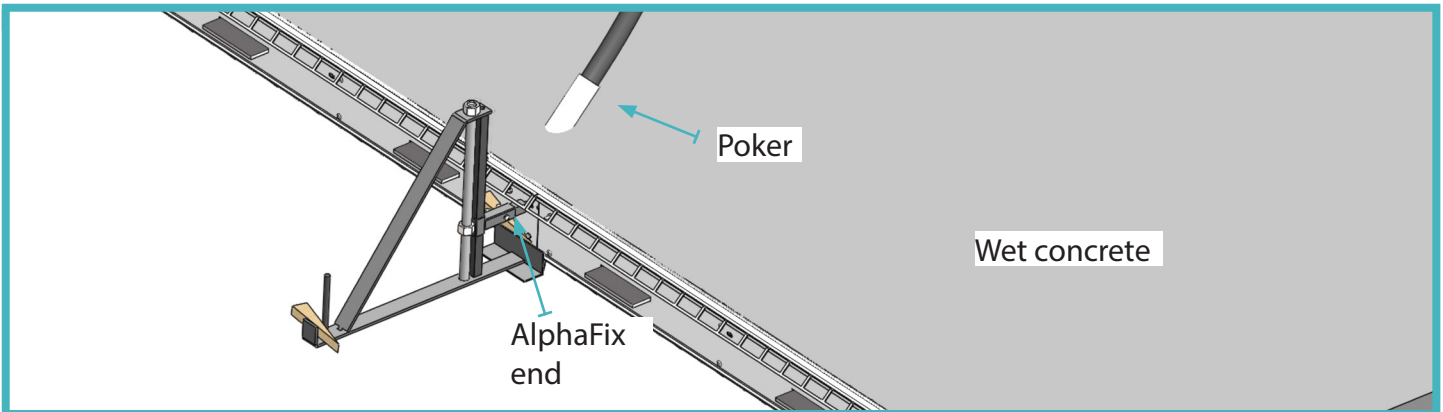

05 Finish

Finish concrete, flush to top of the Joint ensuring the rail is clearly visible. Before next side is cast, cut Joints support pins.