

# Permadeck Type 2®

Specification Sheet

Issue 1.1

01/04/2025

Permadeck Type 2®

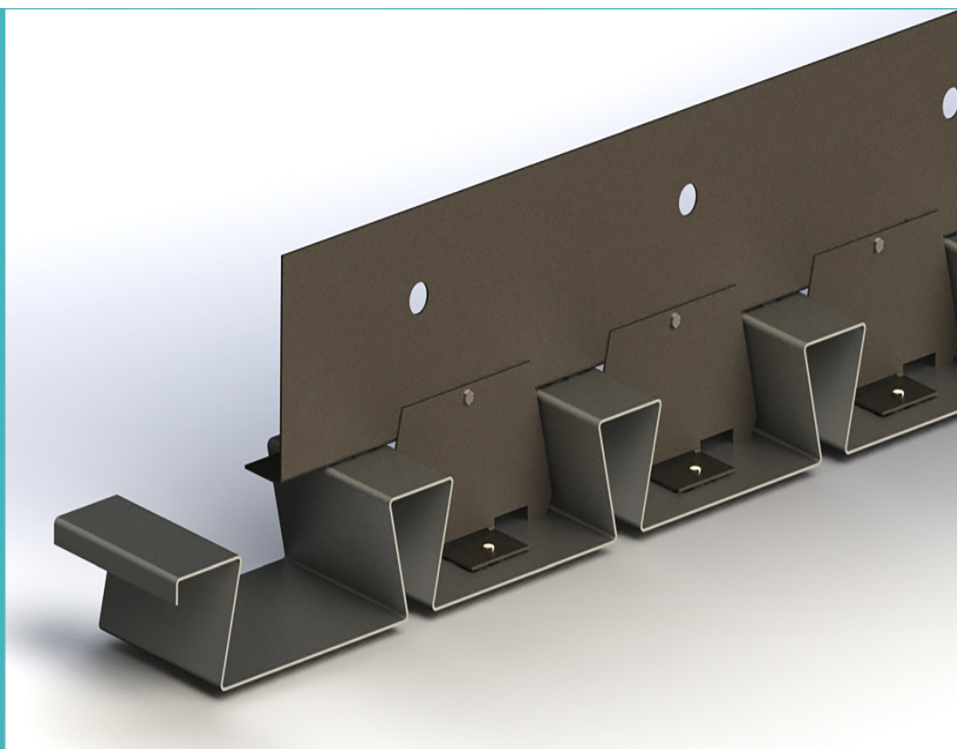

Permadeck Type 2®

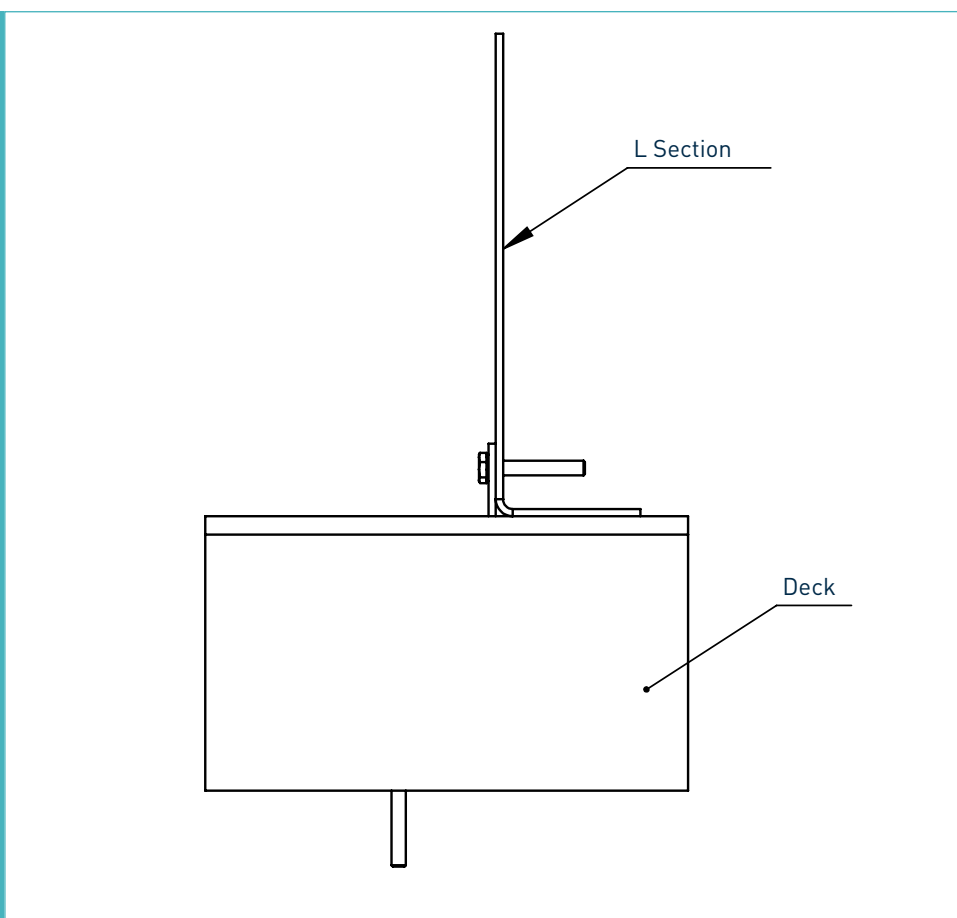

# Permadeck Type 2®

Specification Sheet

Issue 1.1

01/04/2025

Permadeck Type 2® Perpendicular



Permadeck Type 2® Peak



Permadeck Type 2® Trough

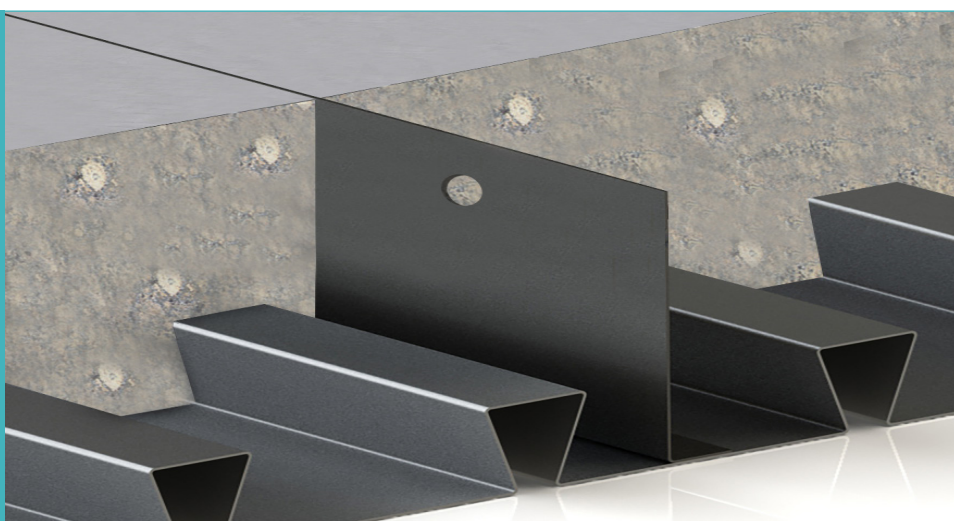

Permadeck Type 2®

Specification Sheet Issue 1.1  
01/04/2025

manufacturing tolerances					
Length	±2.0mm	Height	±1mm	Straightness	±0.5mm/600mm

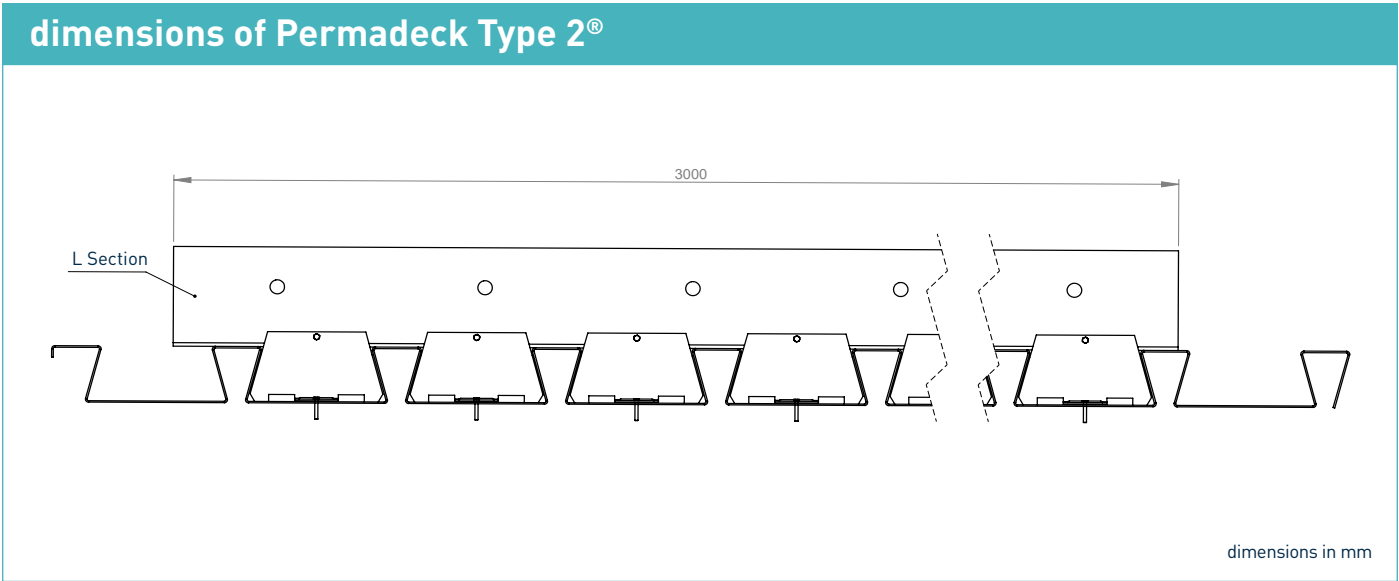

materials	
Component	Material
Sheet steel formwork	EN 10130 : 2006 DC01

This deck joint is a new, easy to use, unique system, which provides formwork for use on metal decking. This is a leave-in-place system which eliminates the need to strip out timber and foam the following day. It provides a more professional finish to joints on deck and a concise detail for engineers to place on their drawings. It also allows for a continuity of the mesh reinforcement through its design. It is suitable for all manufacturers and deck, as the deck inserts are interchangeable to suit the deck profile.